



Matrix with Counter-bore Relief

Code: **MKB**

Blank type & with starting holes for wire-edm ISO 8977

Material: 1.3343 (M2) Hardness: 60 - 62 HRC

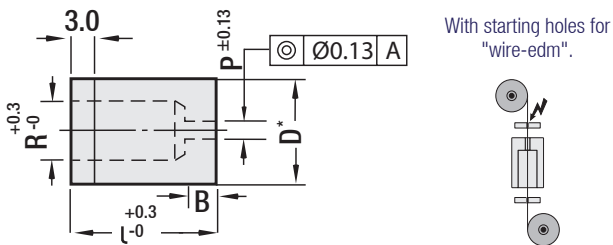

Headed Matrix with Counter-bore Relief

Code: **MLB**

Blank type & with starting holes for wire-edm ISO 8977

Material: 1.3343 (M2) Hardness: 60 - 62 HRC

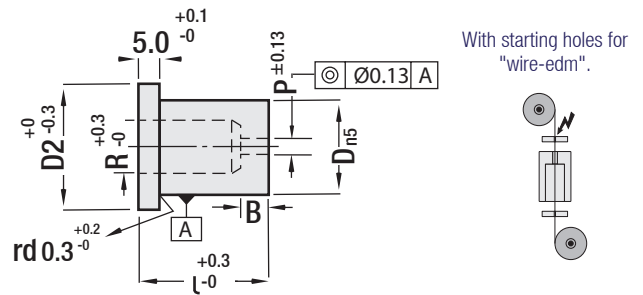

D mm	P mm	B point length		R mm	l mm
		S (standard)	A (optional)		
8.0	0.8	-	-	-	20
10.0	0.8	4	8	6.0	
13.0	1.6	5	8	8.0	22
16.0	1.6	5	8	9.5	25
20.0	1.6	5	12	12.0	28
22.0	1.6	6	12	15.0	30
25.0	1.6	6	12	17.5	32
28.0	1.6	6	12	17.5	35
30.0	1.6	6	12	17.5	40
32.0	1.6	6	12	21.0	60
35.0	1.6	6	12	21.0	
38.0	1.6	8	12	27.0	Selection as per request
40.0	1.6	8	12	27.0	
45.0	3.2	8	12	36.0	
50.0	3.2	8	12	41.0	

D mm	D2 mm	P mm	B point length		R mm	l mm
			S (standard)	A (optional)		
8.0	11	0.8	-	-	-	20
10.0	13	0.8	4	8	6.0	
13.0	16	1.6	5	8	8.0	22
16.0	19	1.6	5	8	9.5	25
20.0	23	1.6	5	12	12.0	28
22.0	25	1.6	6	12	15.0	30
25.0	28	1.6	6	12	17.5	32
28.0	31	1.6	6	12	17.5	35
30.0	33	1.6	6	12	17.5	40
32.0	35	1.6	6	12	21.0	Selection as per request
35.0	38	1.6	6	12	21.0	
38.0	41	1.6	8	12	27.0	
40.0	43	1.6	8	12	27.0	

 Order: **MKB. D x l - B**

Order Example:
MKB. 20 x 32 - S

 Order: **MLB. D x l - B**

Order Example:
MLB. 25 x 30 - S